

Accessories Mounting Sockets

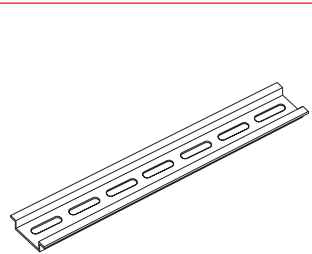

DIN Rail

Description

Industry standard 35 mm aluminum or steel DIN rail. C103PM aluminum rail is available in 36 in. (91.4 cm) lengths. 017322005 zinc bichromate plated steel rail is available in 78 in. (2 m) lengths.

P/N: C103PM (Al)
017322005 (Steel)

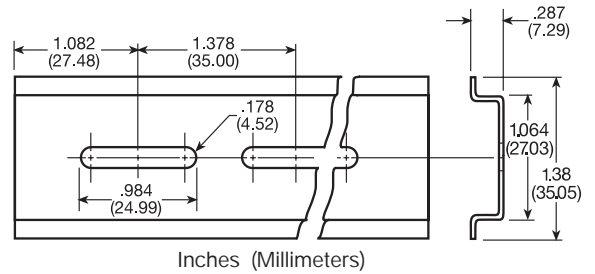

Inches (Millimeters)

C103PM Aluminum Rail
(Prepunched cut out dimensions are approximate.)

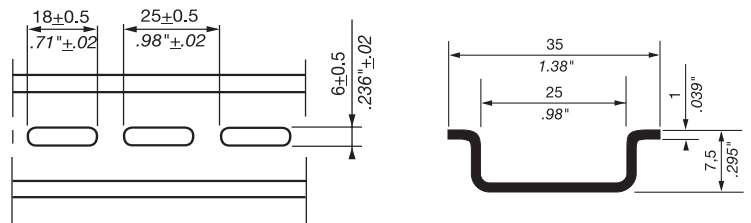

Inches (Millimeters)

017322005 Zinc Bichromate Plated Steel Rail
(Prepunched cut out dimensions are approximate.)



Approvals: 

Surface Mount Sockets

8 Pin Octal Socket (600 VAC)

Description

8 pin surface mount socket with binder head screw terminals. Rated 10 A at 600 V AC. When used with TDM, TDB, TDS Series timers the combination is UL Listed. Uses PSCRB8 hold-down brackets.

P/N: P1011-6

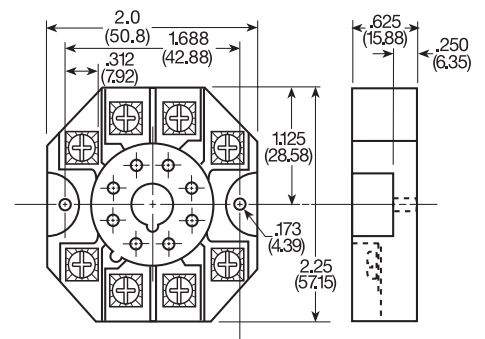

Inches (Millimeters)

Hold-Down Brackets

Description

Designed for use with P1011-6 socket. Securely mounts 8 pin plug-in controls in any position, and provides protection against vibration. Comes in sets of two.

P/N: PSCRB8

